

★
T.O. 21M-HGM25A-6-1WC-1PE

ONE, SET
(141 CARDS)

HGM-25A
MISSILE WEAPON SYSTEM

PHASED INSPECTION AND
LUBRICATION WORK CARDS

LAUNCH COMPLEX

12-14

WWW.CHROMEHOOVES.NET

**CHANGE
NOTICE**

LATEST CHANGED PAGES SUPERSEDE
THE SAME PAGES OF PREVIOUS DATE

Insert changed pages into basic
publication. Destroy superseded pages.

WWW.CHROMEHOOVES.NET

PUBLISHED UNDER AUTHORITY OF THE
SECRETARY OF THE AIR FORCE

★

Reproduction for nonmilitary use of the information or illustrations contained in this publication is not permitted without specific approval of the issuing service. The policy for use of Classified Publications is established for the Air Force in AFR 205-1.

INSERT LATEST CHANGED PAGES, DESTROY SUPERSEDED PAGES

LIST OF EFFECTIVE PAGES

NOTE: The portion of the text affected by the changes is indicated by a vertical line in the outer margins of the page.

**TOTAL NUMBER OF PAGES IN THIS PUBLICATION IS 247
CONSISTING OF THE FOLLOWING:**

<u>CARD NO.</u>	<u>ISSUE</u>	<u>CARD NO.</u>	<u>ISSUE</u>
* Title	21 Sept 64		
* A	21 Sept 64	Backup 2-10	.Original
B	Original	2-11.Original
C Blank	Original	Backup 2-11	.Original
i thru ia	Original	2-12.Original
ii thru iih	Original	Backup 2-12	.Original
ij	Original	2-13.Original
iii	Original	Backup 2-13	.Original
iiia Blank	Original	2-14.Original
iv thru ivw	Original	Backup 2-14	.Original
1-1 thru 1-30	Original	2-15.Original
*1-31	21 Sept 64	Backup 2-15	.Original
*1-32 Deleted	21 Sept 64	2-16.Original
1-33 thru 1-77	Original	Backup 2-16	.Original
2-1 thru 2-2	Original	2-17.Original
Backup 2-2	Original	Backup 2-17	.Original
2-3.	Original	2-18.Original
Backup 2-3	Original	Backup 2-18	.Original
2-4.	Original	2-19.Original
Backup 2-4	Original	Backup 2-19	.Original
2-5.	Original	2-20.Original
Backup 2-5	Original	Backup 2-20	.Original
2-6.	Original	2-21.Original
Backup 2-6	Original	Backup 2-21	.Original
2-7.	Original	2-22.Original
Backup 2-7	Original	Backup 2-22	.Original
2-8.	Original	2-23.Original
Backup 2-8	Original	Backup 2-23	.Original
2-9.	Original	2-24.Original
Backup 2-9	Original	Backup 2-24	.Original
2-10	Original	2-25.Original
		Backup 2-25	.Original

*The asterisk indicates pages changed, added, or deleted by the current change.

ADDITIONAL COPIES OF THIS PUBLICATION MAY BE OBTAINED AS FOLLOWS:
USAF ACTIVITIES. — In accordance with T.O. 00-5-2.

USAF

<u>CARD NO.</u>	<u>ISSUE</u>	<u>CARD NO.</u>	<u>ISSUE</u>
2-26	Original	2-49	Original
Backup 2-26.	Original	Backup 2-49.	Original
2-27	Original	2-50	Original
Backup 2-27.	Original	Backup 2-50.	Original
2-28	Original	2-51	Original
Backup 2-28.	Original	Backup 2-51.	Original
2-29	Original	2-52	Original
Backup 2-29.	Original	Backup 2-52.	Original
2-30	Original	2-53	Original
Backup 2-30.	Original	Backup 2-53.	Original
2-31	Original	2-54	Original
Backup 2-31.	Original	Backup 2-54.	Original
2-32	Original	2-55	Original
Backup 2-32.	Original	Backup 2-55.	Original
2-33	Original	2-56	Original
Backup 2-33.	Original	Backup 2-56.	Original
2-34	Original	2-57	Original
Backup 2-34.	Original	Backup 2-57.	Original
2-35	Original	2-58	Original
Backup 2-35.	Original	Backup 2-58.	Original
2-36	Original	2-59	Original
Backup 2-36.	Original	Backup 2-59.	Original
2-37	Original	2-60	Original
Backup 2-37.	Original	Backup 2-60.	Original
2-38	Original	2-61	Original
Backup 2-38.	Original	Backup 2-61.	Original
2-39	Original	2-62	Original
Backup 2-39.	Original	Backup 2-62.	Original
2-40	Original	2-63	Original
Backup 2-40.	Original	Backup 2-63.	Original
2-41	Original	2-64	Original
Backup 2-41.	Original	Backup 2-64.	Original
2-42	Original	2-65	Original
Backup 2-42.	Original	Backup 2-65.	Original
2-43	Original		
Backup 2-43.	Original		
2-44	Original		
Backup 2-44.	Original		
2-45	Original		
Backup 2-45.	Original		
2-46	Original		
Backup 2-46.	Original		
2-47	Original		
Backup 2-47.	Original		
2-48	Original		
Backup 2-48.	Original		

*The asterisk indicates pages changed, added, or deleted by the current change.

INTRODUCTION

These inspection work cards implement the requirements of the Inspection Requirements Manual, and will be used as a guide in performing an inspection to insure that no item is overlooked. The total work card requirements are grouped into 36 phased inspections by the Work Organization and Flow (WOF) charts which must be performed in sequence. Phased inspections will be accomplished at frequency required to meet periodic requirements of fuel exercise and lox only combined systems exercise (CSE) indicated in the Inspection Requirements Manual. Individual work cards will be accomplished as indicated by phased inspections and will become overdue if not accomplished during the applicable phased inspection. The card size affords convenient handling by maintenance personnel while performing an inspection. Work assignment information is provided at the top of each card to permit establishment of a convenient filing system for the set of cards and to make it possible to readily select any particular card or group of cards in making work assignments to maintenance personnel. To afford more efficient maintenance planning and assignment of work, the requirements are arranged by work areas utilizing separate cards for requirements to be accomplished.

The WOF charts are provided as a guide for planning and controlling accomplishment of inspection/maintenance requirements in an orderly sequence. These charts indicate the most logical sequence for accomplishing each phased inspection during the recovery phase of a successful exercise. Resequencing may be accomplished if required by unscheduled maintenance. The circular figures represent the functions performed during a normal fuel exercise or lox CSE. The hexagon figures represent those work cards that can be performed in conjunction with the Combined Systems Exercise activities. The dash line(s) which connect the work card hexagon directly to circular CSE function(s) will be performed simultaneously with the CSE function(s). Those work cards which should be performed during a specified period of time are identified by solid lines extending from the hexagonal

INTRODUCTION

figure(s) to the solid lines which connect the circular figures. . These work cards are to be accomplished within the span of time indicated by points of intersection. Hexagonal figures may contain single or multiple work cards.

The inspection requirements on each work card are arranged to provide a logical sequence of performance of the requirements pertaining to the area or areas to which the card applies. Detailed instructions for use of these cards and the description and application of other forms and charts to be used in conjunction with these cards are contained in T.O. 00-20E1. The data on card-ii and on subsequent cards indicate the location, code, and title of work areas which are referred to in this set of cards.

Recommendations proposing changes to these work cards are encouraged and should be submitted on AFTO Form 22, Attn: DMM, Technical Data Branch, through appropriate command headquarters as per T.O. 00-5-1.

LIST OF TIME COMPLIANCE TECHNICAL ORDERS

This technical order includes all changes, additions, and deletions made necessary by issuance of the following time compliance technical orders:

TCTO Number	Date
31X7-1-529	25 January 1963
31X3-10-11-634	4 March 1964

WWW.CHROMEHOOVES.NET

WWW.CHROMEHOOVES.NET

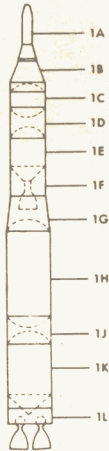

WWW.CHROMEHOOVES.NET

MISSILE WORK AREAS

- 1A. RE-ENTRY VEHICLE
- 1B. STAGE II TRANSITION COMPARTMENT
- 1C. STAGE II FUEL TANK
- 1D. STAGE II BETWEEN TANKS COMPARTMENT
- 1E. STAGE II LOX TANK
- 1F. STAGE II ENGINE COMPARTMENT
- 1G. STAGE I TRANSITION COMPARTMENT
- 1H. STAGE I LOX TANK
- 1J. STAGE I BETWEEN TANKS COMPARTMENT
- 1K. STAGE I FUEL TANK
- 1L. STAGE I ENGINE COMPARTMENT

WWW.CHROMEHOOVES.NET

WWW.CHROMEHOOVES.NET

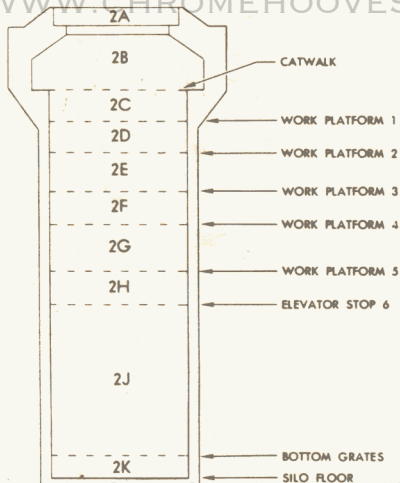

WWW.CHROMEHOOVES.NET

MISSILE SILO WORK AREAS

- 2A. SILO MOUTH
- 2B. SILO MOUTH THRU CATWALK
- 2C. CATWALK THRU WORK PLATFORM 1
- 2D. WORK PLATFORM 1 THRU WORK PLATFORM 2
- 2E. WORK PLATFORM 2 THRU WORK PLATFORM 3
- 2F. WORK PLATFORM 3 THRU WORK PLATFORM 4
- 2G. WORK PLATFORM 4 THRU WORK PLATFORM 5
- 2H. WORK PLATFORM 5 THRU ELEVATOR STOP 6
- 2J. ELEVATOR STOP 6 THRU BOTTOM GRATES
(NOT INCLUDING LAUNCHER)
- 2K. BOTTOM GRATES THRU SILO FLOOR
- 2L. LAUNCHER PLATFORM (NOT SHOWN)
- 2M. UMBILICAL TOWER (NOT SHOWN)

WWW.CHROMEHOOVES.NET

WWW.CHROMEHOOVES.NET

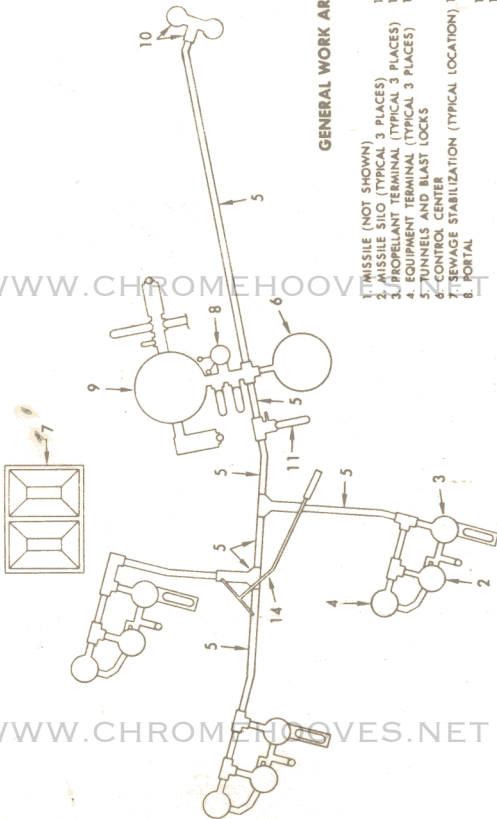

GENERAL WORK AREAS

- 1. MISSILE (NOT SHOWN)
- 2. MISSILE SILO (TYPICAL 3 PLACES)
- 3. PROPELLANT TERMINAL (TYPICAL 3 PLACES)
- 4. EQUIPMENT TERMINAL (TYPICAL 3 PLACES)
- 5. TUNNELS AND BLAST LOCKS
- 6. CONTROL CENTER
- 7. SEWAGE STABILIZATION (TYPICAL LOCATION)
- 8. PORTAL
- 9. POWER HOUSE
- 10. ANTENNA TERMINAL
- 11. FUEL STORAGE AREA
- 12. MISSILE ASSEMBLY AND MAINTENANCE SHOPS (NOT SHOWN)
- 13. SURVEILLANCE AND INSPECTION BUILDING (NOT SHOWN)
- 14. LAUNCHER AREA AIR FILTRATION
- 15. SURFACE

6035133

WWW.CHROMEHOOVES.NET

6035134

WWW.CHROMEHOOVES.NET

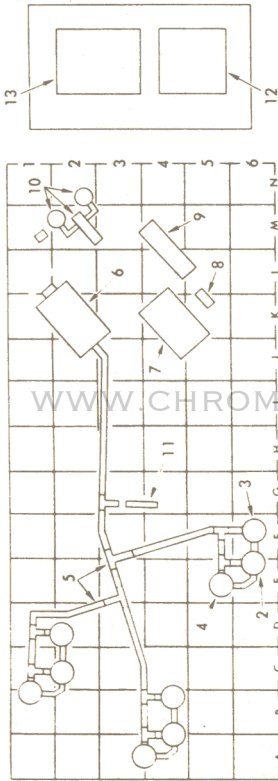

GENERAL WORK AREAS (VAFB)

THE GRID WILL LOCATE ITEMS THAT ARE ON THE SURFACE BY USE OF THE ALPHA NUMERICAL CODE

- 1. MISSILE (NOT SHOWN)
- 2. MISSILE SILO
- 3. PROPELLANT TERMINAL
- 4. EQUIPMENT TERMINAL
- 5. TUNNELS AND BLAST LOCKS
- 6. CONTROL CENTER
- 7. SPRAY POND
- 8. PUMP HOUSE

- 9. POWER HOUSE
- 10. ANTENNA TERMINAL AND SILOS
- 11. FUEL STORAGE AREA
- 12. MISSILE ASSEMBLY BUILDING
- 13. SURVEILLANCE AND INSPECTION BUILDING

WWW.CHROMEHOOVES.NET

WWW.CHROMEHOOVES.NET

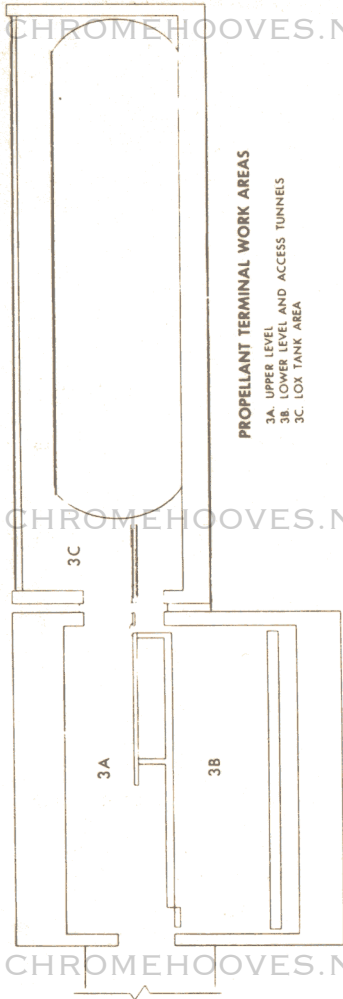

WWW.CHROMEHOOVES.NET

WWW.CHROMEHOOVES.NET

WWW.CHROMEHOOVES.NET

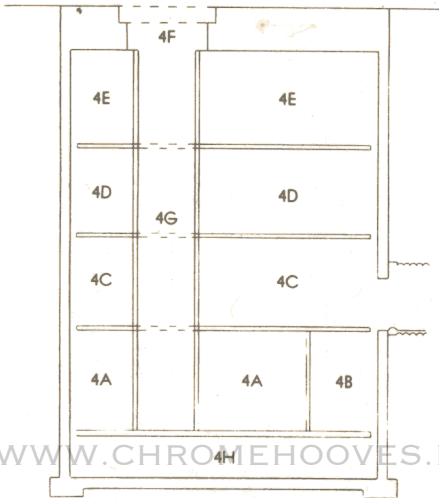

WWW.CHROMEHOOVES.NET

EQUIPMENT TERMINAL WORK AREAS

- 4A. HYDRAULIC SUPPLY ROOM
- 4B. ELECTRICAL ROOM LEVEL 1
- 4C. LEVEL II AND UTILITY TUNNEL
- 4D. LEVEL III
- 4E. LEVEL IV
- 4F. ACCESS
- 4G. ELEVATOR SHAFT
- 4H. SUMP AREA

WWW.CHROMEHOOVES.NET

WWW.CHROMEHOOVES.NET

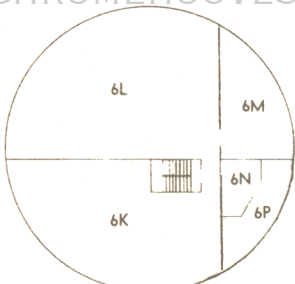

UPPER LEVEL

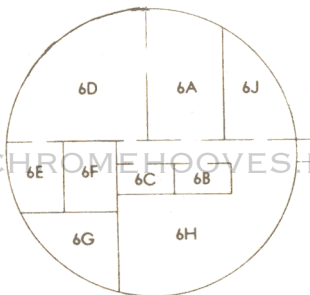

LOWER LEVEL

CONTROL CENTER WORK AREAS

- 6A. ELECTRICAL EQUIPMENT ROOM
- 6B. STAIRS TO UPPER LEVEL
- 6C. COMMUNICATIONS VAULT
- 6D. AIRMEN READY ROOM
- 6E. LATRINE
- 6F. DINING ROOM AND PANTRY
- 6G. OFFICERS READY ROOM
- 6H. READY MAINTENANCE ROOM
- 6J. MECHANICAL EQUIPMENT ROOM
- 6K. COMMUNICATIONS EQUIPMENT ROOM
- 6L. OPERATIONS ROOM
- 6M. LAUNCH COMPLEX OFFICE
- 6N. LATRINE
- 6P. JANITOR AREA

WWW.CHROMEHOOVES.NET

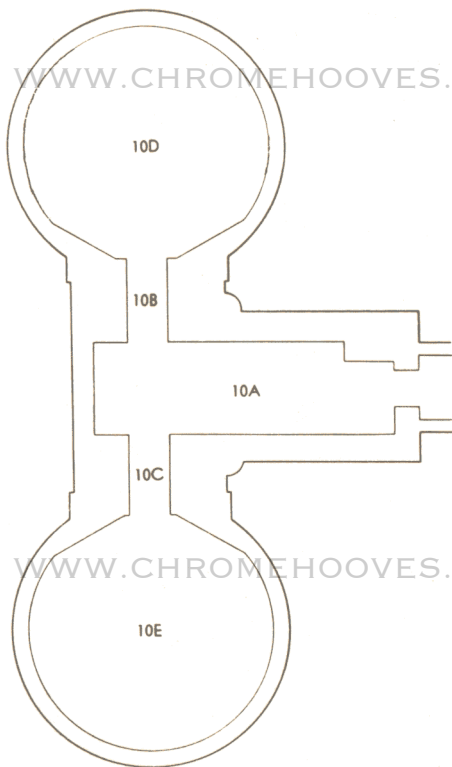

ANTENNA TERMINAL WORK AREAS

- WWW.CHROMEHOOVES.NET
- 10A. ANTENNA ROOM
 - 10B. ACCESS TUNNEL A
 - 10C. ACCESS TUNNEL B
 - 10D. ANTENNA SILO A
 - 10E. ANTENNA SILO B

6035L40

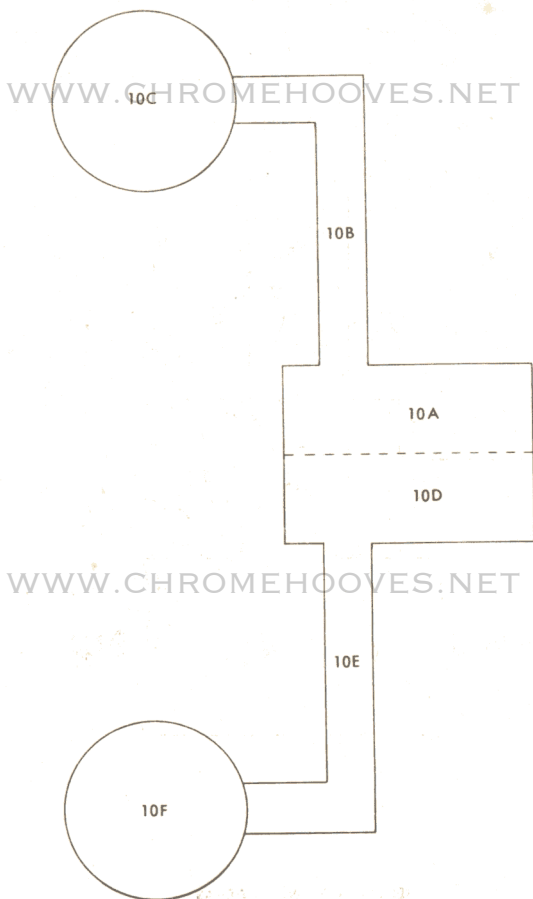

ANTENNA TERMINAL AND SILO WORK AREAS (VAFB)

- 10A. ANTENNA TERMINAL (ANTENNA A EQUIPMENT)
- 10B. ACCESS TUNNEL A
- 10C. ANTENNA SILO A
- 10D. ANTENNA TERMINAL (ANTENNA B EQUIPMENT)
- 10E. ACCESS TUNNEL B
- 10F. ANTENNA SILO B

WWW.CHROMEHOOVES.NET

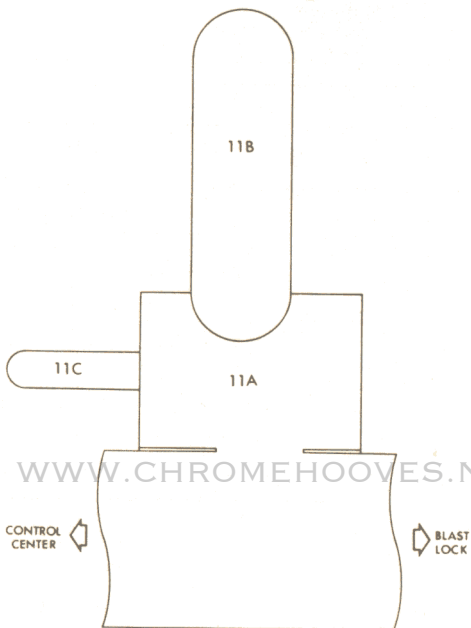

FUEL STORAGE WORK AREAS

- 11A. ROOM
- 11B. FUEL STORAGE TANK
- 11C. NITROGEN STORAGE TANK

WWW.CHROMEHOOVES.NET

T. O. 21M-HGM25A-6-1WC-1PE

TABLE OF CONTENTS

SECTION I	INSPECTION AND CALIBRATION REQUIREMENTS.....	1-1
SECTION II	LUBRICATION REQUIREMENTS.....	2-1

WWW.CHROMEHOOVES.NET

WWW.CHROMEHOOVES.NET

8 May 1964

iii/iiia